

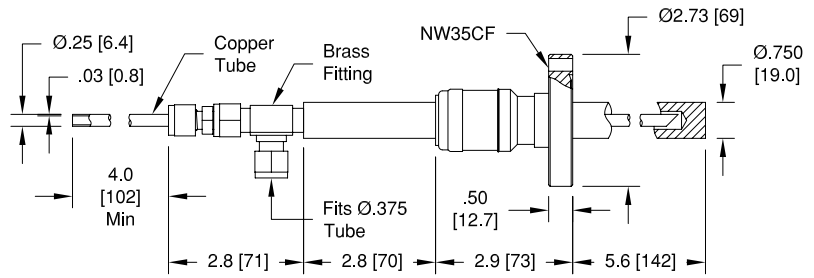

.750 [19.0] Dia. Conductor
One Conductor - Liquid Cooled
 Installation: 2 3/4" ConFlat (NW35CF)



Voltage DC	Conductor Amps	Conductor Material	Pressure @ 20°C		Temperature °C		Magnetic Materials	Ceramaseal Part Number	List Price
			PSIG	Bar	Min	Max			
8 kV	1000	Tellurium Copper	250	17	-269	450	Yes	17112-01-CF	\$755

For flange assembly instructions see page L24 - L25. For lead attachment see page K19.

Feedthrough

Multipin Connector

Coaxial

Thermocouple

Isolator

Viewport

Pressure

Baseplate

Crystal Sensor

Heater

Accessories

www.ceramaseal.com

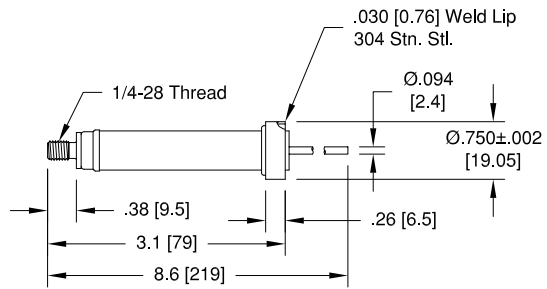
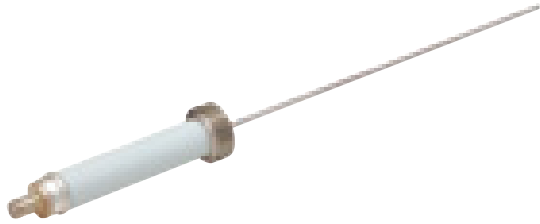

DC Voltage: 20 KV

One Conductor

Installation: Weld

Amps	Conductor Material	Pressure @ 20 °C		Temperature °C		Magnetic Materials	Ceramaseal Part Number	List Price
		PSIG	Bar	Min	Max			
3.6	304 Str. Stl.	250	17	-269	450	Yes	14837-02-W	\$80
16.5	Nickel	250	17	-269	450	Yes	14837-01-W	\$80
55	Copper	250	17	-269	450	Yes	14837-03-W	\$80

For welding instructions see page L23. For lead attachment see pages K14 - K19. For thread connection see page L27.

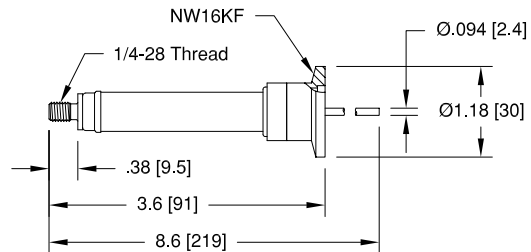

DC Voltage: 20 KV

One Conductor

Installation: NW16KF

Amps	Conductor Material	Pressure @ 20 °C		Temperature °C		Magnetic Materials	Ceramaseal Part Number	List Price
		PSIG*	Bar*	Min	Max			
3.6	304 Str. Stl.	0	0	-25	205	Yes	17102-01-KF	\$120
16.5	Nickel	0	0	-25	205	Yes	17102-02-KF	\$120
55	Copper	0	0	-25	205	Yes	17102-03-KF	\$120

For flange assembly instructions see page L26. For lead attachment see pages K14 - K19. For thread connection see page L27. *An overpressure ring is required for internal pressurized use from 5 to 100 psig [0.3 to 7 bar].

www.ceramaseal.com

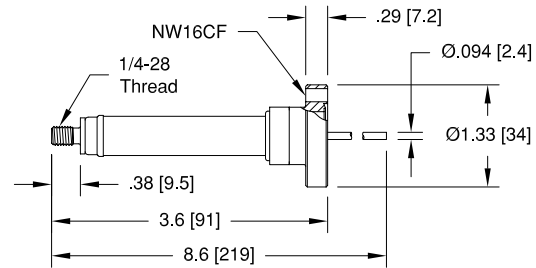

DC Voltage: 20 KV

One Conductor

Installation: 1 1/3" ConFlat (NW16CF)

Amps	Conductor Material	Pressure @ 20°C		Temperature °C		Magnetic Materials	Ceramaseal Part Number	List Price
		PSIG	Bar	Min	Max			
3.6	304 Stn. Stl.	250	17	-269	450	Yes	17101-01-CF	\$120
16.5	Nickel	250	17	-269	450	Yes	17101-02-CF	\$120
55	Copper	250	17	-269	450	Yes	17101-03-CF	\$120

For flange assembly instructions see pages L24 - L25. For lead attachment see pages K14 - K19. For thread connection see page L27.

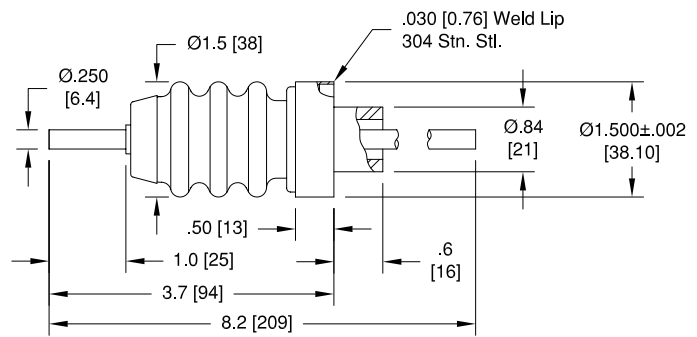

DC Voltage: 20 KV

One Conductor

Installation: Weld

Amps	Conductor Material	Pressure @ 20°C		Temperature °C		Magnetic Materials	Ceramaseal Part Number	List Price
		PSIG	Bar	Min	Max			
12	304 Stn. Stl.	250	17	-269	450	Yes	5159-04-W	\$185
56	Nickel	250	17	-269	450	Yes	5159-02-W	\$185
185	Copper	250	17	-269	450	Yes	5159-05-W	\$185

For welding instructions see page L23. For lead attachment see page K19.

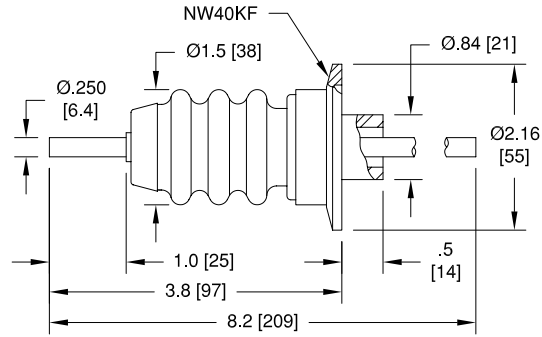

DC Voltage: 20 KV

One Conductor

Installation: NW40KF

Amps	Conductor Material	Pressure @ 20 °C		Temperature °C		Magnetic Materials	Ceramaseal Part Number	List Price
		PSIG*	Bar*	Min	Max			
12	304 Stn. Stl.	0	0	-25	205	Yes	14813-03-KF	\$230
56	Nickel	0	0	-25	205	Yes	14813-04-KF	\$230
185	Copper	0	0	-25	205	Yes	14813-01-KF	\$230

For flange assembly instructions see page L26. For lead attachment see page K19. *An overpressure ring is required for internal pressurized use from 5 to 100 psig [0.3 to 7 bar].

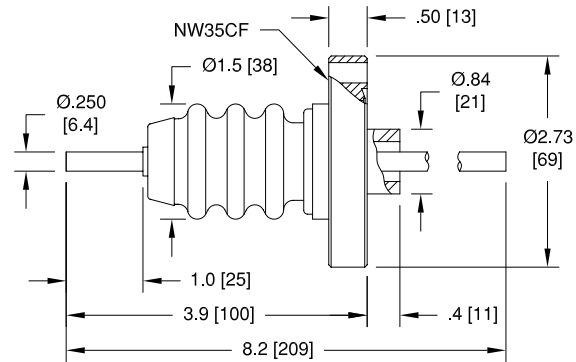
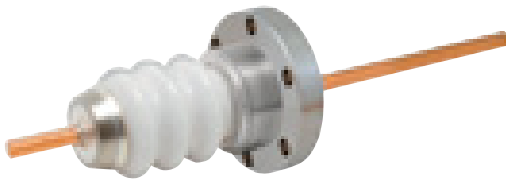

DC Voltage: 20 KV

One Conductor

Installation: 2 3/4" ConFlat (NW35CF)

Amps	Conductor Material	Pressure @ 20 °C		Temperature °C		Magnetic Materials	Ceramaseal Part Number	List Price
		PSIG	Bar	Min	Max			
12	304 Stn. Stl.	250	17	-269	450	Yes	16703-03-CF	\$230
56	Nickel	250	17	-269	450	Yes	16703-01-CF	\$230
185	Copper	250	17	-269	450	Yes	16703-02-CF	\$230

For flange assembly instructions see pages L24 - L25. For lead attachment see page K19.

www.ceramaseal.com

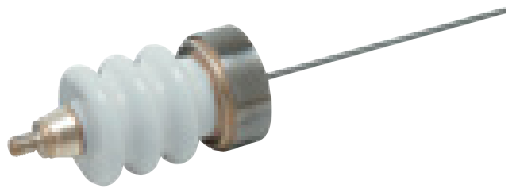

DC Voltage: 20 KV
 One Conductor
 Installation: Weld

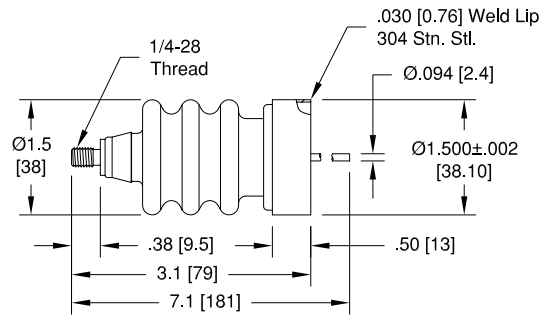

Amps	Conductor Material	Pressure @ 20°C		Temperature °C		Magnetic Materials	Ceramaseal Part Number	List Price
		PSIG	Bar	Min	Max			
3.6	304 Stn. Stl.	250	17	-269	450	Yes	6530-01-W	\$130
16.5	Nickel	250	17	-269	450	Yes	6530-11-W	\$130
55	Copper	250	17	-269	450	Yes	6530-04-W	\$130

For welding instructions see page L23. For lead attachment see pages K18 - K19. For thread connection see page L27.



DC Voltage: 20 KV
 One Conductor
 Installation: NW40KF

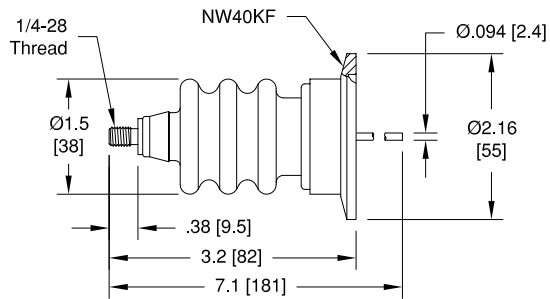

Amps	Conductor Material	Pressure @ 20°C		Temperature °C		Magnetic Materials	Ceramaseal Part Number	List Price
		PSIG*	Bar*	Min	Max			
3.6	304 Stn. Stl.	0	0	-25	205	Yes	17100-02-KF	\$175
16.5	Nickel	0	0	-25	205	Yes	17100-04-KF	\$175
55	Copper	0	0	-25	205	Yes	17100-06-KF	\$175

For flange assembly instructions see page L26. For lead attachment see pages K18 - K19. For thread connection see page L27. *An overpressure ring is required for internal pressurized use from 5 to 100 psig [0.3 to 7 bar].

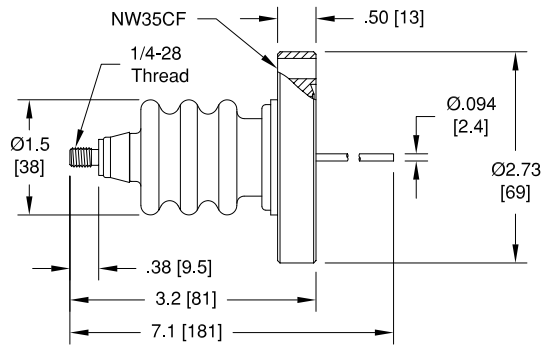
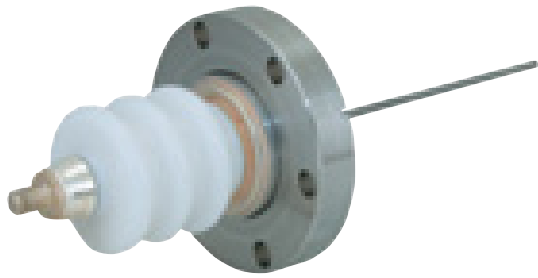

DC Voltage: 20 KV

One Conductor

Installation: 2 3/4" ConFlat (NW35CF)

Amps	Conductor Material	Pressure @ 20 °C		Temperature °C		Magnetic Materials	Ceramaseal Part Number	List Price
		PSIG	Bar	Min	Max			
3.6	304 Stn. Stl.	250	17	-269	450	Yes	16729-01-CF	\$175
16.5	Nickel	250	17	-269	450	Yes	16729-10-CF	\$175
55	Copper	250	17	-269	450	Yes	16729-04-CF	\$175

For flange assembly instructions see pages L24 - L25. For lead attachment see pages K18 - K19. For thread connection see page L27.

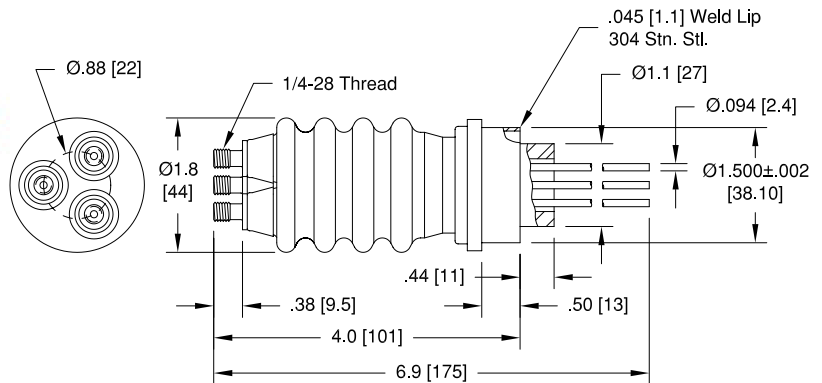

DC Voltage: 25 KV

Three Conductors

Installation: Weld

Amps	Conductor Material	Pressure @ 20 °C		Temperature °C		Magnetic Materials	Ceramaseal Part Number	List Price
		PSIG	Bar	Min	Max			
3.6	304 Stn. Stl.	250	17	-269	450	Yes	1890-04-W	\$585
16.5	Nickel	250	17	-269	450	Yes	1890-05-W	\$585
55	Copper	250	17	-269	450	Yes	1890-01-W	\$585

For welding instructions see page L23. For lead attachment see pages K18 - K19. For thread connection see page L27.

www.ceramaseal.com

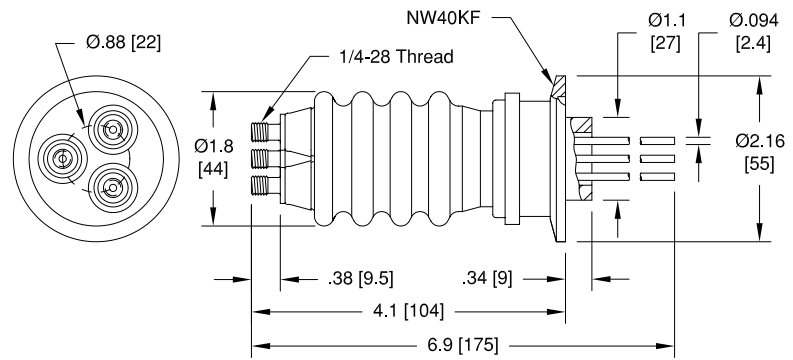

DC Voltage: 25 KV
 Three Conductors
 Installation: NW40KF

Amps	Conductor Material	Pressure @ 20°C		Temperature °C		Magnetic Materials	Ceramaseal Part Number	List Price
		PSIG*	Bar*	Min	Max			
3.6	304 Stn. Stl.	0	0	-25	205	Yes	17104-03-KF	\$630
16.5	Nickel	0	0	-25	205	Yes	17104-02-KF	\$630
55	Copper	0	0	-25	205	Yes	17104-01-KF	\$630

For flange assembly instructions see page L26. For lead attachment see pages K18 - K19. For thread connection see page L27. *An overpressure ring is required for internal pressurized use from 5 to 100 psig [0.3 to 7 bar].

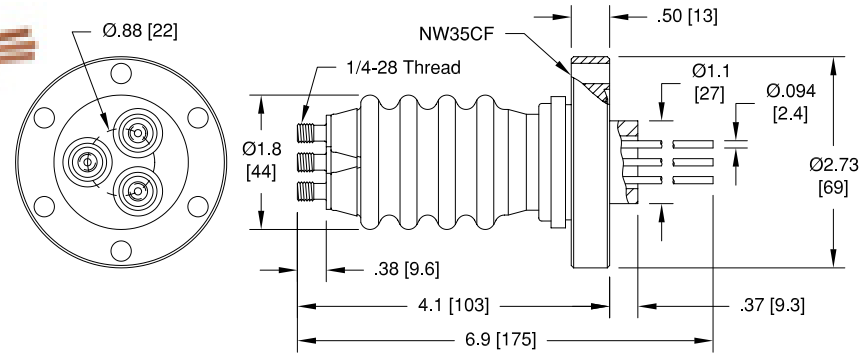

DC Voltage: 25 KV
 Three Conductors
 Installation: 2 3/4" ConFlat (NW35CF)

Amps	Conductor Material	Pressure @ 20°C		Temperature °C		Magnetic Materials	Ceramaseal Part Number	List Price
		PSIG	Bar	Min	Max			
3.6	304 Stn. Stl.	250	17	-269	450	Yes	13092-04-CF	\$630
16.5	Nickel	250	17	-269	450	Yes	13092-05-CF	\$630
55	Copper	250	17	-269	450	Yes	13092-01-CF	\$630

For flange assembly instructions see pages L24 - L25. For lead attachment see pages K18 - K19. For thread connection see page L27.

www.ceramaseal.com

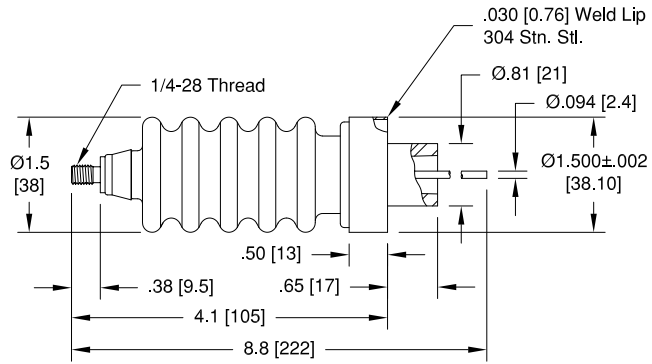

DC Voltage: 30 KV

One Conductor

Installation: Weld

Amps	Conductor Material	Pressure @ 20°C		Temperature °C		Magnetic Materials	Ceramaseal Part Number	List Price
		PSIG	Bar	Min	Max			
3.6	304 Stn. Stl.	250	17	-269	450	Yes	6530-03-W	\$145
16.5	Nickel	250	17	-269	450	Yes	6530-09-W	\$145
55	Copper	250	17	-269	450	Yes	6530-06-W	\$145

For welding instructions see page L23. For lead attachment see pages K18 - K19. For thread connection see page L27.

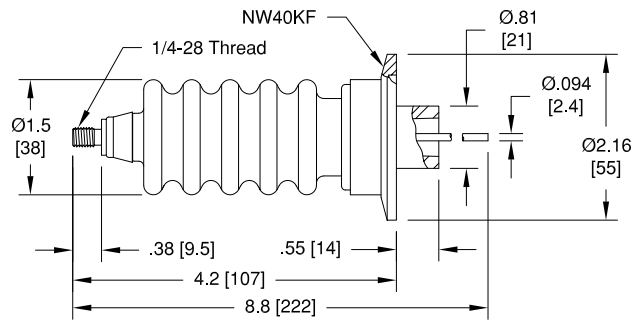

DC Voltage: 30 KV

One Conductor

Installation: NW40KF

Amps	Conductor Material	Pressure @ 20°C		Temperature °C		Magnetic Materials	Ceramaseal Part Number	List Price
		PSIG*	Bar*	Min	Max			
3.6	304 Stn. Stl.	0	0	-25	205	Yes	17100-01-KF	\$200
16.5	Nickel	0	0	-25	205	Yes	17100-03-KF	\$200
55	Copper	0	0	-25	205	Yes	17100-05-KF	\$200

For flange assembly instructions see page L26. For lead attachment see pages K18 - K19. For thread connection see page L27. *An overpressure ring is required for internal pressurized use from 5 to 100 psig [0.3 to 7 bar].

www.ceramaseal.com



DC Voltage: 30 KV

One Conductor

Installation: 2 3/4" ConFlat (NW35CF)

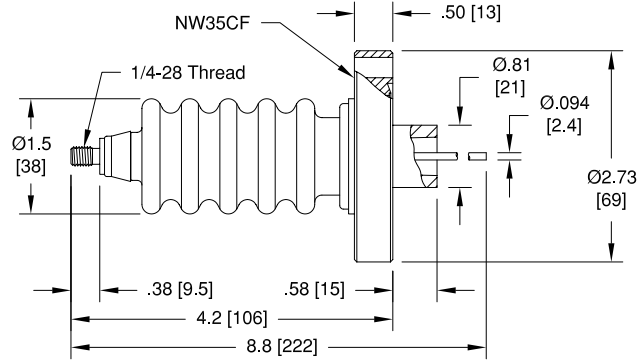

Amps	Conductor Material	Pressure @ 20°C		Temperature °C		Magnetic Materials	Ceramaseal Part Number	List Price
		PSIG	Bar	Min	Max			
3.6	304 Stn. Stl.	250	17	-269	450	Yes	16729-03-CF	\$200
16.5	Nickel	250	17	-269	450	Yes	16729-09-CF	\$200
55	Copper	250	17	-269	450	Yes	16729-06-CF	\$200

For flange assembly instructions see pages L24 - L25. For lead attachment see pages K18 - K19. For thread connection see page L27.



DC Voltage: 30 KV

Two Conductors

Installation: Weld

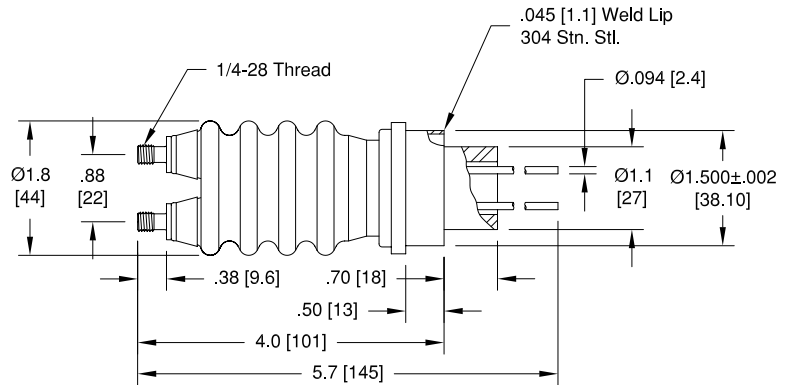

Amps	Conductor Material	Pressure @ 20°C		Temperature °C		Magnetic Materials	Ceramaseal Part Number	List Price
		PSIG	Bar	Min	Max			
3.6	304 Stn. Stl.	250	17	-269	450	Yes	6532-05-W	\$345
16.5	Nickel	250	17	-269	450	Yes	6532-02-W	\$345
55	Copper	250	17	-269	450	Yes	6532-01-W	\$345

For welding instructions see page L23. For lead attachment see pages K18 - K19. For thread connection see page L27.

Feedthrough
 Multipin Connector
 Coaxial
 Thermocouple
 Isolator
 Viewport
 Pressure
 Baseplate
 Crystal Sensor
 Heater
 Accessories

www.ceramaseal.com

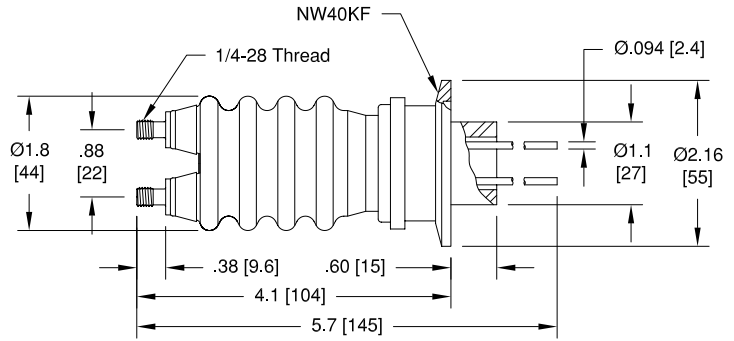

DC Voltage: 30 KV

Two Conductors

Installation: NW40KF

Amps	Conductor Material	Pressure @ 20°C		Temperature °C		Magnetic Materials	Ceramaseal Part Number	List Price
		PSIG*	Bar*	Min	Max			
3.6	304 Stn. Stl.	0	0	-25	205	Yes	17103-03-KF	\$385
16.5	Nickel	0	0	-25	205	Yes	17103-02-KF	\$385
55	Copper	0	0	-25	205	Yes	17103-01-KF	\$385

For flange assembly instructions see page L26. For lead attachment see pages K18 - K19. For thread connection see page L27. *An overpressure ring is required for internal pressurized use from 5 to 100 psig [0.3 to 7 bar].

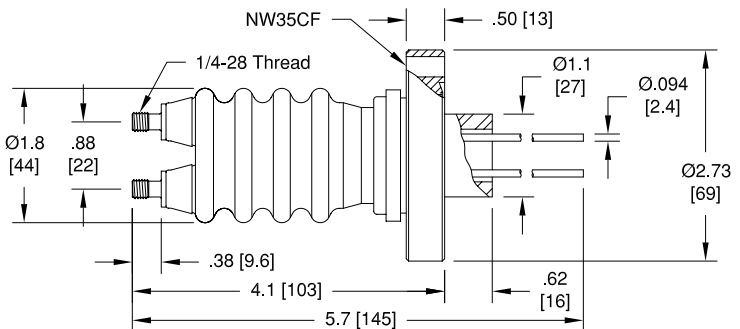

DC Voltage: 30 KV

Two Conductors

Installation: 2 3/4" ConFlat (NW35CF)

Amps	Conductor Material	Pressure @ 20°C		Temperature °C		Magnetic Materials	Ceramaseal Part Number	List Price
		PSIG	Bar	Min	Max			
3.6	304 Stn. Stl.	250	17	-269	450	Yes	16764-06-CF	\$385
16.5	Nickel	250	17	-269	450	Yes	16764-02-CF	\$385
55	Copper	250	17	-269	450	Yes	16764-01-CF	\$385

For flange assembly instructions see pages L24 - L25. For lead attachment see pages K18 - K19. For thread connection see page L27.

www.ceramaseal.com



DC Voltage: 50 KV
 One Conductor
 Installation: Weld

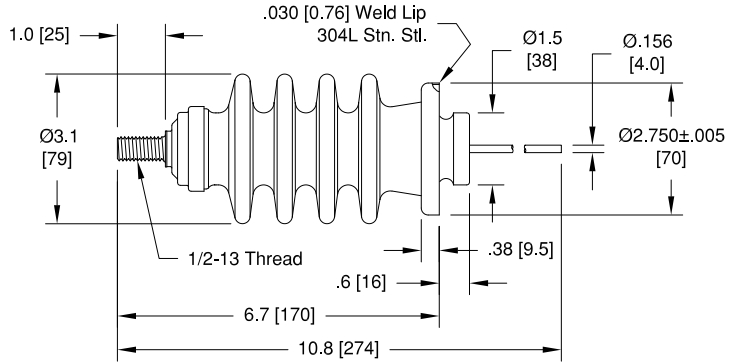

Amps	Conductor Material	Pressure @ 20°C		Temperature °C		Magnetic Materials	Ceramaseal Part Number	List Price
		PSIG	Bar	Min	Max			

6.5	304 Stn. Stl.	125	8.6	-75	200	No	17056-01-W	\$140
30	Nickel	125	8.6	-75	200	Yes	17056-03-W	\$140
100	Copper	125	8.6	-75	200	No	17056-05-W	\$140

For welding instructions see page L23. For lead attachment see page K19. For thread connection see page L27.



DC Voltage: 50 KV
 One Conductor
 Installation: 6" ConFlat (NW100CF)

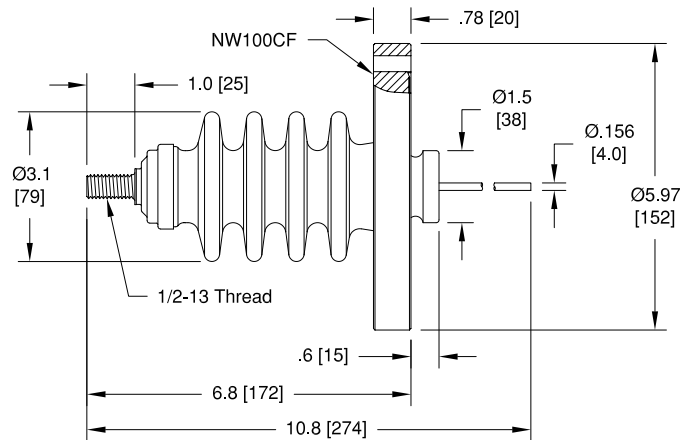

Amps	Conductor Material	Pressure @ 20°C		Temperature °C		Magnetic Materials	Ceramaseal Part Number	List Price
		PSIG	Bar	Min	Max			

6.5	304 Stn. Stl.	125	8.6	-75	200	No	17056-02-CF	\$315
30	Nickel	125	8.6	-75	200	Yes	17056-04-CF	\$315
100	Copper	125	8.6	-75	200	No	17056-06-CF	\$315

For flange assembly instructions see pages L24 - L25. For lead attachment see page K19. For thread connection see page L27.

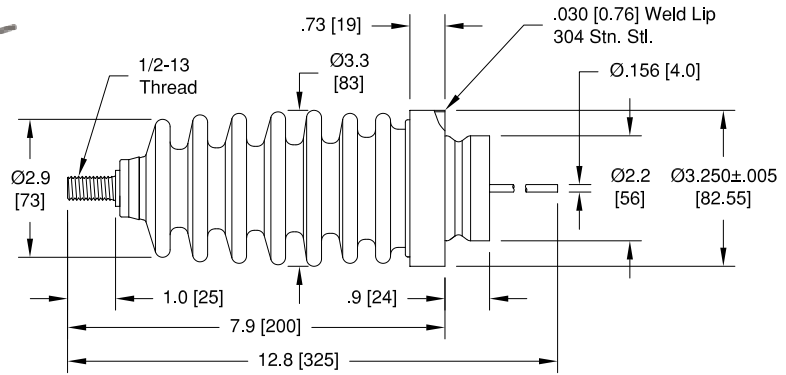

DC Voltage: 70 KV

One Conductor

Installation: Weld

Amps	Conductor Material	Pressure @ 20 °C		Temperature °C		Magnetic Materials	Ceramaseal Part Number	List Price
		PSIG	Bar	Min	Max			
6.5	304 Stn. Stl.	125	8.6	-269	450	Yes	6526-01-W	\$775
30	Nickel	125	8.6	-269	450	Yes	6526-04-W	\$775
100	Copper	125	8.6	-269	450	Yes	6526-05-W	\$775

For welding instructions see page L23. For lead attachment see page K19. For thread connection see page L27.

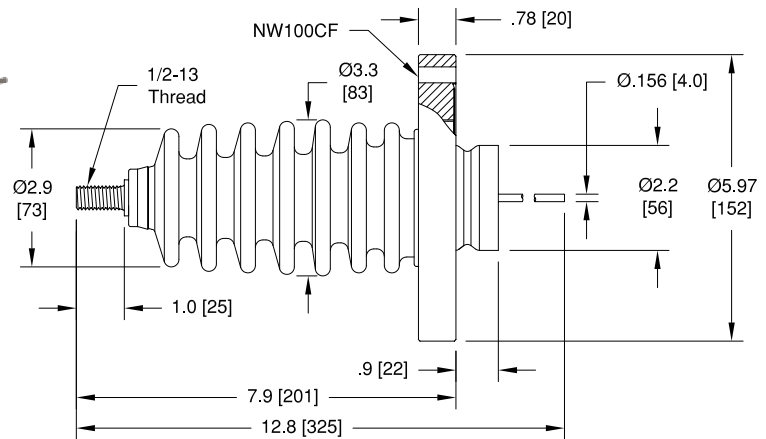

DC Voltage: 70 KV

One Conductor

Installation: 6" ConFlat (NW100CF)

Amps	Conductor Material	Pressure @ 20 °C		Temperature °C		Magnetic Materials	Ceramaseal Part Number	List Price
		PSIG	Bar	Min	Max			
6.5	304 Stn. Stl.	125	8.6	-269	450	Yes	7884-01-CF	\$950
30	Nickel	125	8.6	-269	450	Yes	7884-03-CF	\$950
100	Copper	125	8.6	-269	450	Yes	7884-02-CF	\$950

For flange assembly instructions see pages L24 - L25. For lead attachment see page K19. For thread connection see page L27.

www.ceramaseal.com

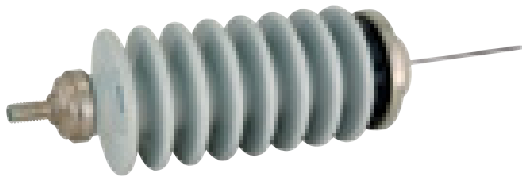

DC Voltage: 90 KV

One Conductor

Installation: Weld

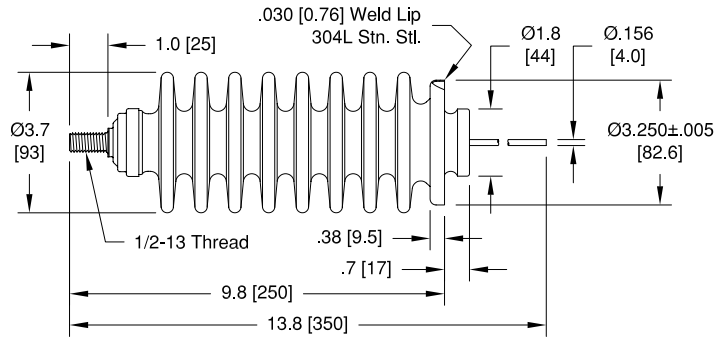

Amps	Conductor Material	Pressure @ 20°C		Temperature °C		Magnetic Materials	Ceramaseal Part Number	List Price
		PSIG	Bar	Min	Max			

6.5	304 Stn. Stl.	125	8.6	-75	200	No	17057-01-W	\$160
30	Nickel	125	8.6	-75	200	Yes	17057-03-W	\$160
100	Copper	125	8.6	-75	200	No	17057-05-W	\$160

For welding instructions see page L23. For lead attachment see page K19. For thread connection see page L27.

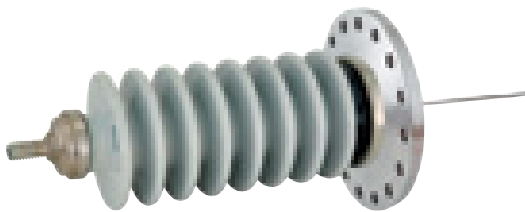

DC Voltage: 90 KV

One Conductor

Installation: 6" ConFlat (NW100CF)

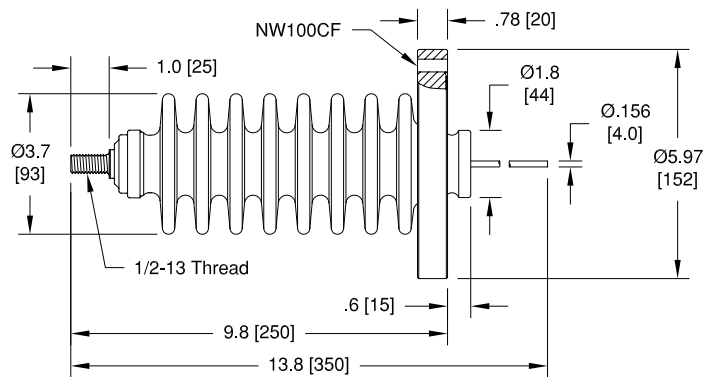

Amps	Conductor Material	Pressure @ 20°C		Temperature °C		Magnetic Materials	Ceramaseal Part Number	List Price
		PSIG	Bar	Min	Max			

6.5	304 Stn. Stl.	125	8.6	-75	200	No	17057-02-CF	\$335
30	Nickel	125	8.6	-75	200	Yes	17057-04-CF	\$335
100	Copper	125	8.6	-75	200	No	17057-06-CF	\$335

For flange assembly instructions see pages L24 - L25. For lead attachment see page K19. For thread connection see page L27.

Feedthrough

Multipin Connector

Coaxial

Thermocouple

Isolator

Viewport

Pressure

Baseplate

Crystal Sensor

Heater

Accessories

www.ceramaseal.com

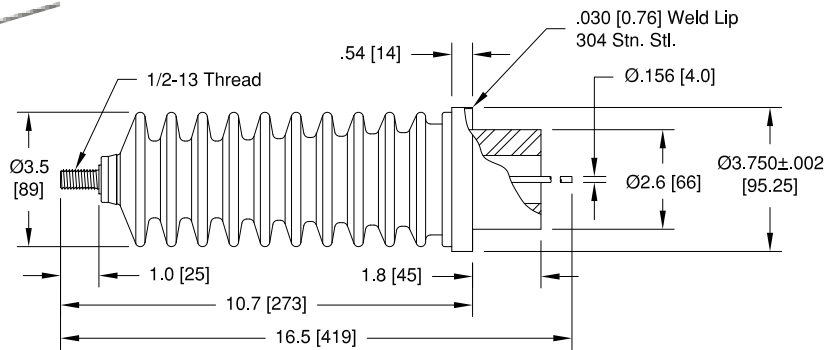

DC Voltage: 100 KV

One Conductor

Installation: Weld

Amps	Conductor Material	Pressure @ 20 °C		Temperature °C		Magnetic Materials	Ceramaseal Part Number	List Price
		PSIG	Bar	Min	Max			
6.5	304 Stn. Stl.	125	8.6	-269	450	Yes	6523-01-W	\$1750
30	Nickel	125	8.6	-269	450	Yes	6523-06-W	\$1750
100	Copper	125	8.6	-269	450	Yes	6523-05-W	\$1750

For welding instructions see page L23. For lead attachment see page K19. For thread connection see page L27.

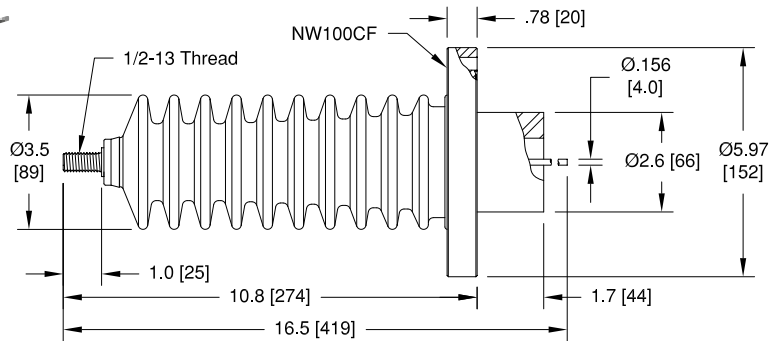

DC Voltage: 100 KV

One Conductor

Installation: 6" ConFlat (NW100CF)

Amps	Conductor Material	Pressure @ 20 °C		Temperature °C		Magnetic Materials	Ceramaseal Part Number	List Price
		PSIG	Bar	Min	Max			
6.5	304 Stn. Stl.	125	8.6	-269	450	Yes	6722-01-CF	\$1925
30	Nickel	125	8.6	-269	450	Yes	6722-03-CF	\$1925
100	Copper	125	8.6	-269	450	Yes	6722-04-CF	\$1925

For flange assembly instructions see pages L24 - L25. For lead attachment see page K19. For thread connection see page L27.

www.ceramaseal.com

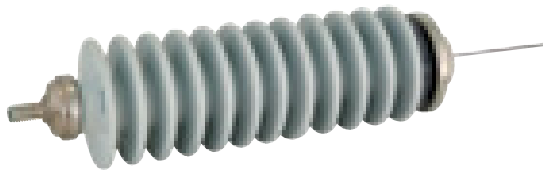

DC Voltage: 125 KV
 One Conductor
 Installation: Weld

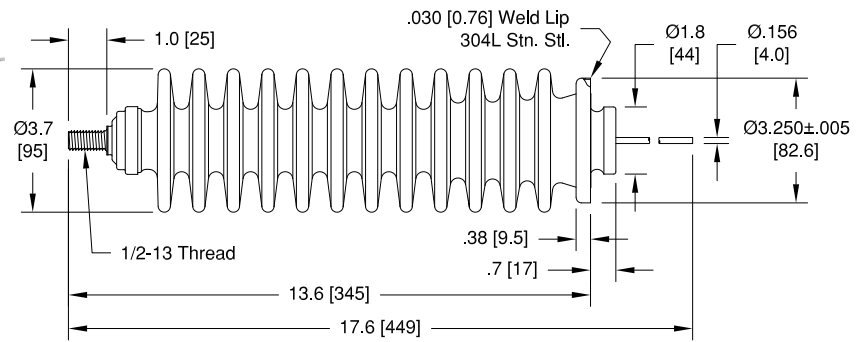

Amps	Conductor Material	Pressure @ 20 °C		Temperature °C		Magnetic Materials	Ceramaseal Part Number	List Price
		PSIG	Bar	Min	Max			
6.5	304 Stn. Stl.	125	8.6	-75	200	No	17058-01-W	\$180
30	Nickel	125	8.6	-75	200	Yes	17058-03-W	\$180
100	Copper	125	8.6	-75	200	No	17058-05-W	\$180

For welding instructions see page L23. For lead attachment see page K19. For thread connection see page L27.



DC Voltage: 125 KV
 One Conductor
 Installation: 6" ConFlat (NW100CF)

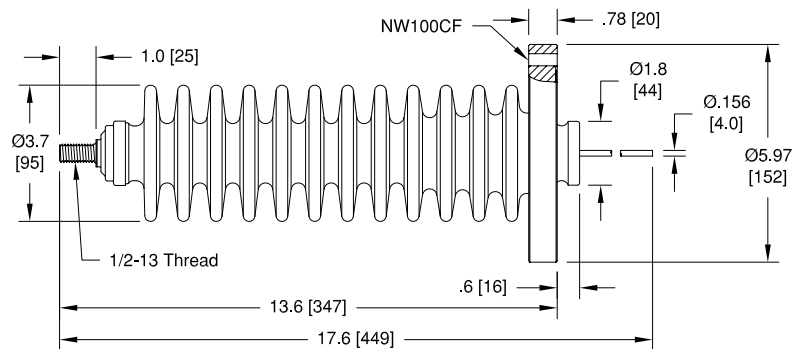

Amps	Conductor Material	Pressure @ 20 °C		Temperature °C		Magnetic Materials	Ceramaseal Part Number	List Price
		PSIG	Bar	Min	Max			
6.5	304 Stn. Stl.	125	8.6	-75	200	No	17058-02-CF	\$355
30	Nickel	125	8.6	-75	200	Yes	17058-04-CF	\$355
100	Copper	125	8.6	-75	200	No	17058-06-CF	\$355

For flange assembly instructions see pages L24 - L25. For lead attachment see page K19. For thread connection see page L27.

Feedthrough
 Multipin Connector
 Coaxial
 Thermocouple
 Isolator
 Viewport
 Pressure
 Baseplate
 Crystal Sensor
 Heater
 Accessories

www.ceramaseal.com

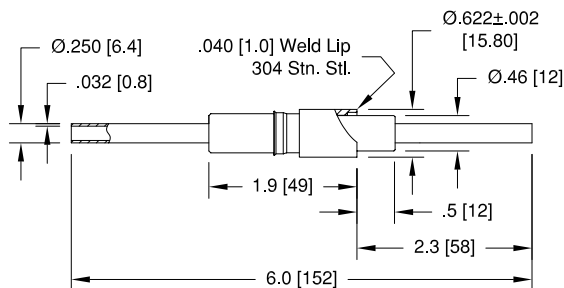

.250 [6.4] Dia. Conductor

One Conductor

Installation: Weld

Voltage DC	Frequency	Conductor Amps	Material	Pressure @ 20 °C PSIG	Pressure @ 20 °C Bar	Temperature °C Min	Temperature °C Max	Magnetic Materials	Ceramaseal Part Number	List Price
------------	-----------	----------------	----------	-----------------------	----------------------	--------------------	--------------------	--------------------	------------------------	------------

14 kV	13.56 MHz	100	Copper Tube	500	35	-55	350	No	16476-01-W	\$400
-------	-----------	-----	-------------	-----	----	-----	-----	----	------------	-------

For welding instructions see page L23. For tube connection see page L27.

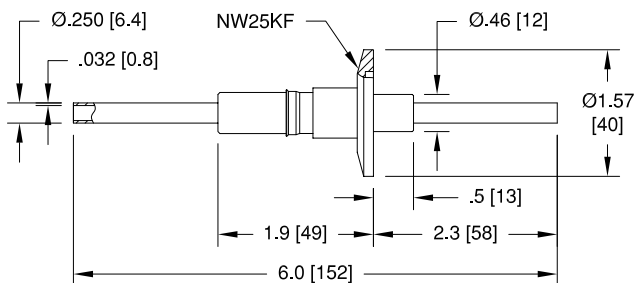
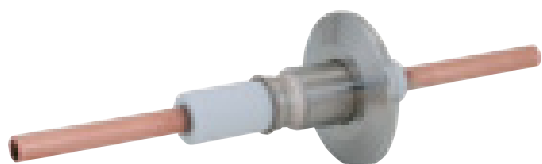

.250 [6.4] Dia. Conductor

One Conductor

Installation: NW25KF

Voltage DC	Frequency	Conductor Amps	Material	Pressure @ 20 °C PSIG*	Pressure @ 20 °C Bar*	Temperature °C Min	Temperature °C Max	Magnetic Materials	Ceramaseal Part Number	List Price
------------	-----------	----------------	----------	------------------------	-----------------------	--------------------	--------------------	--------------------	------------------------	------------

14 kV	13.56 MHz	100	Copper Tube	0	0	-25	205	No	16959-01-KF	\$450
-------	-----------	-----	-------------	---	---	-----	-----	----	-------------	-------

For flange assembly instructions see page L26. For tube connection see page L27. *An overpressure ring is required for internal pressurized use from 5 to 100 psig [0.3 to 7 bar].

www.ceramaseal.com

Feedthrough
Multipin Connector
Coaxial
Thermocouple
Isolator
Viewport
Pressure
Baseplate
Crystal Sensor
Heater
Accessories

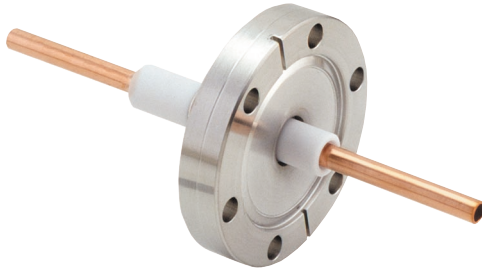

.250 [6.4] Dia. Conductor

One Conductor

Installation: 2 3/4" ConFlat (NW35CF)

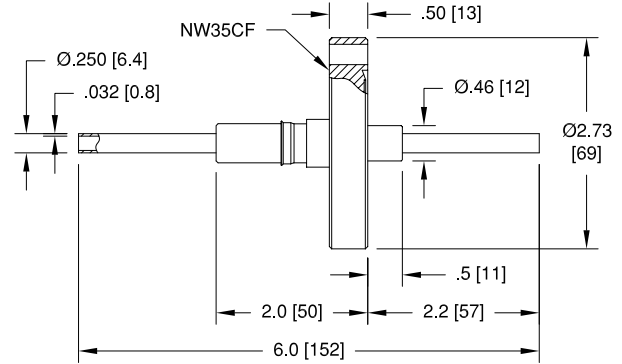

Voltage DC	Frequency	Conductor Amps	Material	Pressure @ 20 °C PSIG Bar	Temperature °C Min Max	Magnetic Materials	Ceramaseal Part Number	List Price
14 kV	13.56 MHz	100	Copper Tube	500 35	-55 350	No	16941-01-CF	\$450

For flange assembly instructions see pages L24 - L25. For tube connection see page L27.

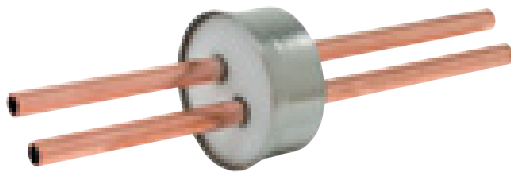

.250 [6.4] Dia. Conductor

Two Conductors

Installation: Weld

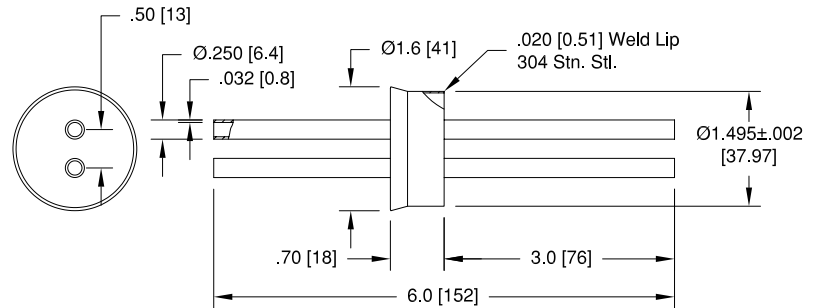

Voltage DC	Frequency	Conductor Amps	Material	Pressure @ 20 °C PSIG Bar	Temperature °C Min Max	Magnetic Materials	Ceramaseal Part Number	List Price
8 kV	100 KHz	300	Copper Tube	125 8.6	-55 350	No	16976-01-W	\$475
	300 KHz	250						
	450 KHz	200						
	13.56 MHz	100						

For welding instructions see page L23. For tube connection see page L27.

Feedthrough
Multipin Connector
Coaxial
Thermocouple
Isolator
Viewport
Pressure
Baseplate
Crystal Sensor
Heater
Accessories

www.ceramaseal.com

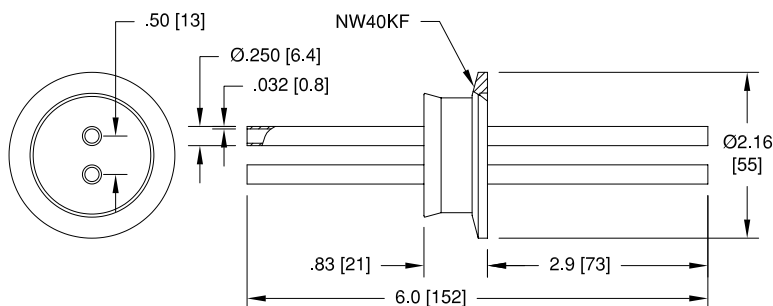
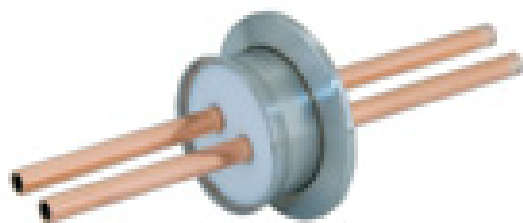

.250 [6.4] Dia. Conductor

Two Conductors

Installation: NW40KF

Voltage DC	Frequency	Conductor Amps	Material	Pressure @ 20 °C PSIG*	Bar*	Temperature °C Min	Max	Magnetic Materials	Ceramaseal Part Number	List Price
8 kV	100 KHz	300	Copper Tube	0	0	-25	205	No	17119-01-KF	\$520
	300 KHz	250								
	450 KHz	200								
	13.56 MHz	100								

For flange assembly instructions see page L26. For tube connection see page L27. *An overpressure ring is required for internal pressurized use from 5 to 100 psig [0.3 to 7 bar].

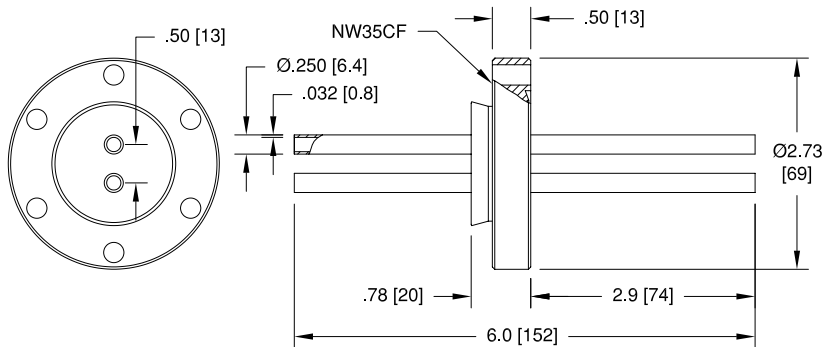
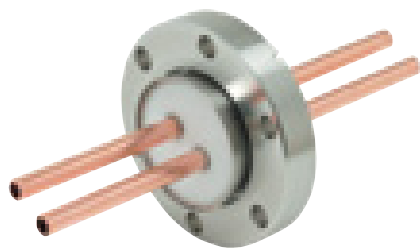

.250 [6.4] Dia. Conductor

Two Conductors

Installation: 2 3/4" ConFlat (NW35CF)

Voltage DC	Frequency	Conductor Amps	Material	Pressure @ 20 °C PSIG	Bar	Temperature °C Min	Max	Magnetic Materials	Ceramaseal Part Number	List Price
8 kV	100 KHz	300	Copper Tube	125	8.6	-55	350	No	16991-01-CF	\$520
	300 KHz	250								
	450 KHz	200								
	13.56 MHz	100								

For flange assembly instructions see pages L24 - L25. For tube connection see page L27.

www.ceramaseal.com

Feedthrough
Multipin Connector
Coaxial
Thermocouple
Isolator
Viewport
Pressure
Baseplate
Crystal Sensor
Heater
Accessories

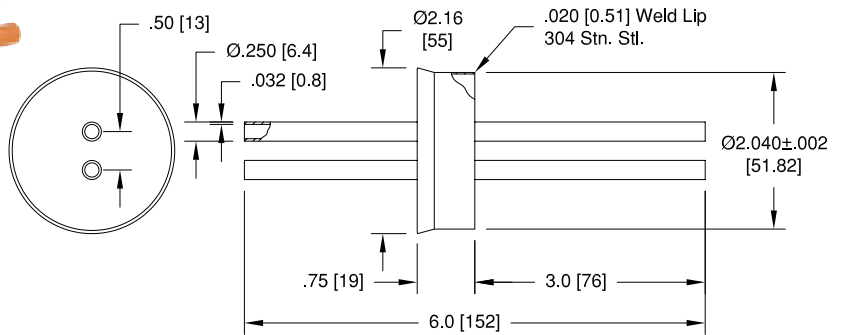
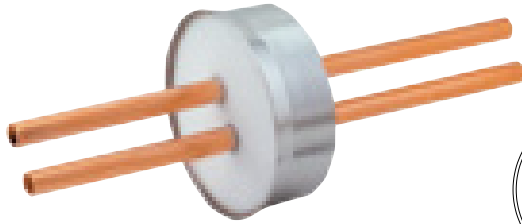

.250 [6.4] Dia. Conductor

Two Conductors

Installation: Weld

Voltage DC	Frequency	Conductor Amps	Material	Pressure @ 20 °C		Temperature °C		Magnetic Materials	Ceramaseal Part Number	List Price
				PSIG	Bar	Min	Max			

8 kV	450 KHz 13.56 MHz	800 100	Copper Tube	75	5.2	-55	350	No	17076-01-W	\$475
------	----------------------	------------	-------------	----	-----	-----	-----	----	------------	-------

For welding instructions see page L23. For tube connection see page L27.

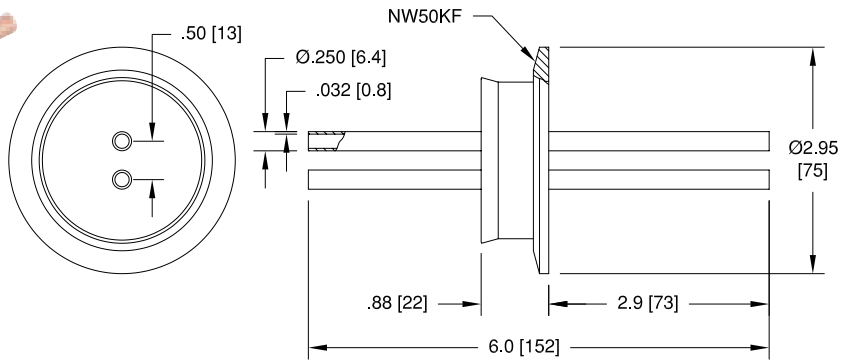
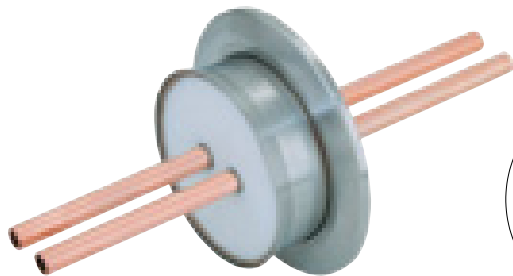

.250 [6.4] Dia. Conductor

Two Conductors

Installation: NW50KF

Voltage DC	Frequency	Conductor Amps	Material	Pressure @ 20 °C		Temperature °C		Magnetic Materials	Ceramaseal Part Number	List Price
				PSIG*	Bar*	Min	Max			

8 kV	450 KHz 13.56 MHz	800 100	Copper Tube	0	0	-25	205	No	17059-01-KF	\$545
------	----------------------	------------	-------------	---	---	-----	-----	----	-------------	-------

For flange assembly instructions see page L26. For tube connection see page L27. *An overpressure ring is required for internal pressurized use from 5 to 100 psig [0.3 to 7 bar].

Feedthrough

Multipin Connector

Coaxial

Thermocouple

Isolator

Viewport

Pressure

Baseplate

Crystal Sensor

Heater

Accessories

www.ceramaseal.com

Feedthrough

RF Power - Liquid Cooled

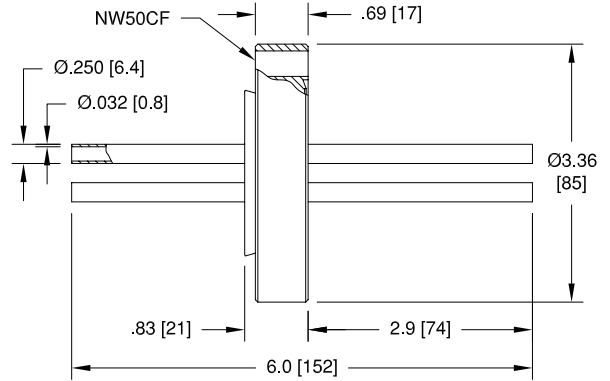
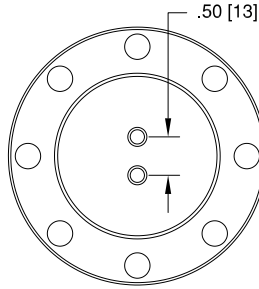
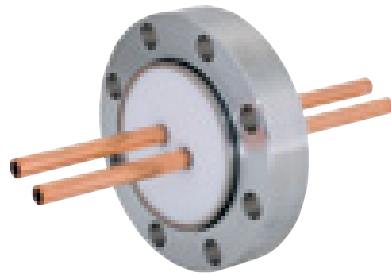

.250 [6.4] Dia. Conductor

Two Conductors

Installation: 3 3/8" ConFlat (NW50CF)

Voltage DC	Frequency	Conductor		Pressure @ 20 °C		Temperature °C		Magnetic Materials	Ceramaseal Part Number	List Price
		Amps	Material	PSIG	Bar	Min	Max			

8 kV	450 KHz 13.56 MHz	800 100	Copper Tube	75	5.2	-55	350	No	17061-01-CF	\$545
------	----------------------	------------	-------------	----	-----	-----	-----	----	-------------	-------

For flange assembly instructions see pages L24 - L25. For tube connection see page L27.

www.ceramaseal.com

Feedthrough
Multipin Connector
Coaxial
Thermocouple
Isolator
Viewport
Pressure
Baseplate
Crystal Sensor
Heater
Accessories